

Organizers



CPD Function

TO BE OR NOT TO BE >>>

From Land and Engineering Surveying to BIM

Organizers:	The Hong Kong Institution of Engineering Surveyors (HKIES) Dept. of Land Surveying & Geo-Informatics, HK PolyU (LSGI)
Speakers:	Mr. LAM Lit Yin Land Surveying Manager Champion Surveying and Engineering Co. Ltd. Mr. SHIH Sywan Min BIM Manager Chun Wo Building Construction and Engineering Co. Ltd
Date:	13-01-2016 (Wed) Time:19:00-20:30 (1.5 hour)
Venue:	Room N001 , The Hong Kong Polytechnic University http://www.polyu.edu.hk/fmo/eMap/map.php
Language:	Cantonese and Mandarin (Supplement with English material)
Admission:	Free of Charge (priority will be given to members of HKIES, LSGI, AIB, BRE HKICW and AIOB)
[CPD cert. would be charged to attendants: \$20 for members of organizers and supporting organizations and \$50 for walk-in guests. No change will be given.]	

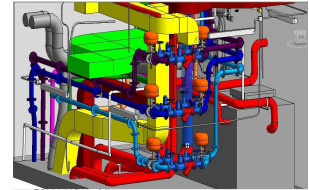

Abstract:

Building Information Modelling (BIM) in construction industry is being applied frequently. Hong Kong Construction Industry Council (HKCIC) will introduce BIM standard to construction industry next year. Great impacts will be brought to land surveying field. From preliminary stage to final stage of construction projects, much survey works can be done to assist BIM applications. In this seminar, the role and adaptation of land surveying to this changing environment will be deeply investigated.

Mr. LAM Lit Yin is the Land Surveying Manager of Champion Surveying and Engineering Co. Ltd. in Hong Kong. He would like to implement photogrammetry and laser scanning to ordinary projects in order to accelerate the pace of land and engineering surveying and enrich the surveying field. He would share experience of how to apply point cloud capturing techniques into various projects and how the technology could integrate with BIM. Mr. LAM is also the Chairman of HKIES since year 2008.

Mr. SHIN Sywan Min, who is the BIM Manager of Chun Wo Building Construction and Engineering Co. Ltd., responds to the formation and application of BIM to various projects. He had worked more than 25 years in BIM management level in different places, such as USA, Beijing, Taiwan, Macau and Hong Kong. He would like to share his opinions to the integration of land surveying and BIM.

Organizers



DEPARTMENT OF
LAND SURVEYING AND GEO-INFORMATICS
土地測量及地理資訊學系

CPD Function

TO BE OR NOT TO BE >>>

From Land and Engineering Surveying to BIM

Please email the reply form to cpd@hkies.org.hk for registration.

All members and guests are welcome and the number of participants is limited to **100**. Participants will be accepted on a first come first served basis. For enquiries, please contact Hilbert WONG (Tel: 96322751), or email to: cpd@hkies.org.hk.

Disclaimer: The Organizers have not arranged any insurance coverage for any participants on any personal accident, property loss/damage or virus inflection arising from this CPD function. Participants should make their own insurance arrangement at their expenses.

Reply Form

Reply Form

I, _____, confirm my intention to attend the CPD Function on **13-01-2016 (Wed)**.

My Membership (HKIES / LSGI / AIB / BRE / AIOB / CICES / HKICW / HKIS / HKIBIM / SEE)* No. _____.

My telephone no. is _____ and e-mail address is _____.

I would / would not * obtain the CPD certificate.

*delete as inappropriate

Please email this reply form to cpd@hkies.org.hk for registration.

[Successful applicants will receive a confirmation email]

Supporting Organizations:

